

Setup Guide T7400A

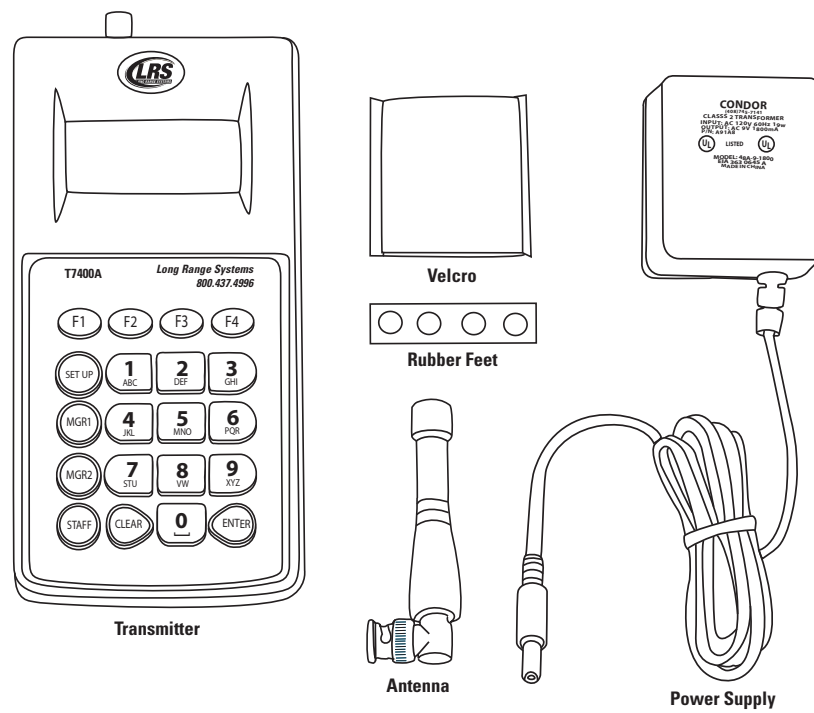

Items Included



1

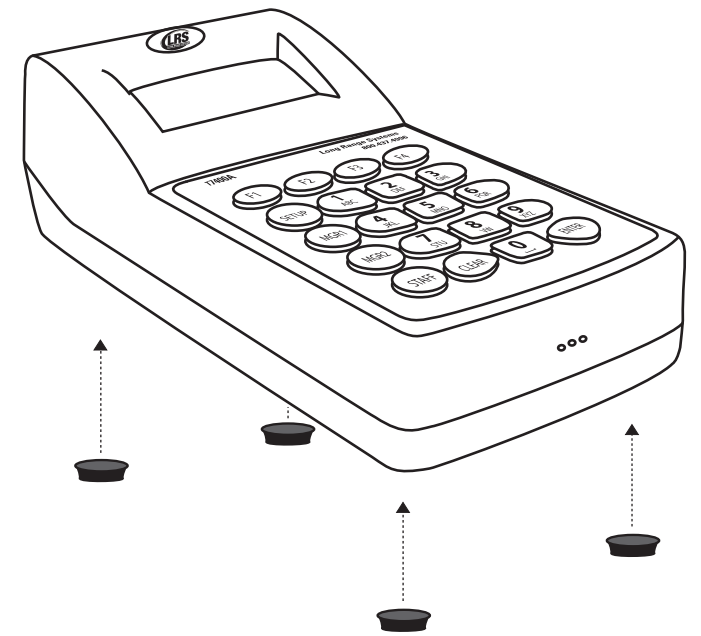

2

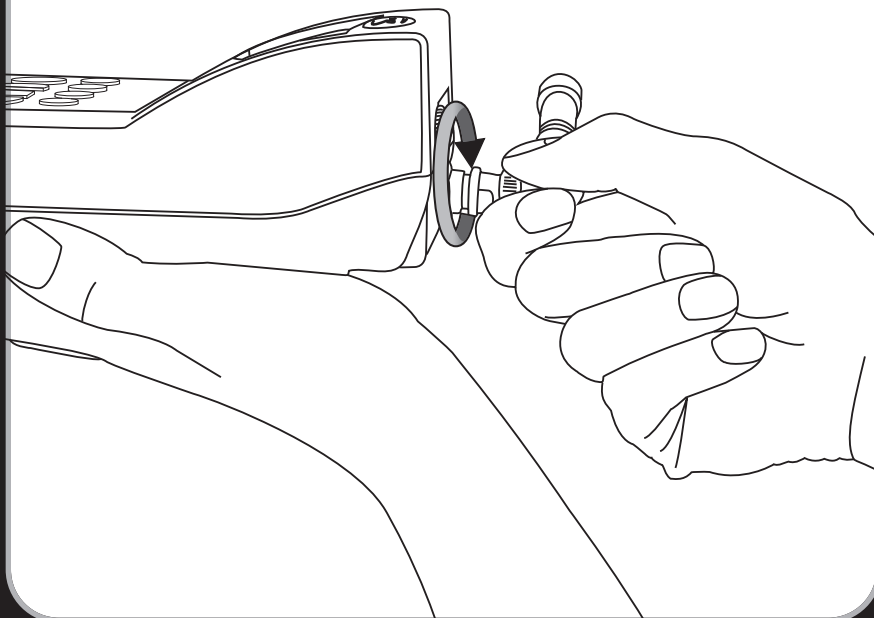

3

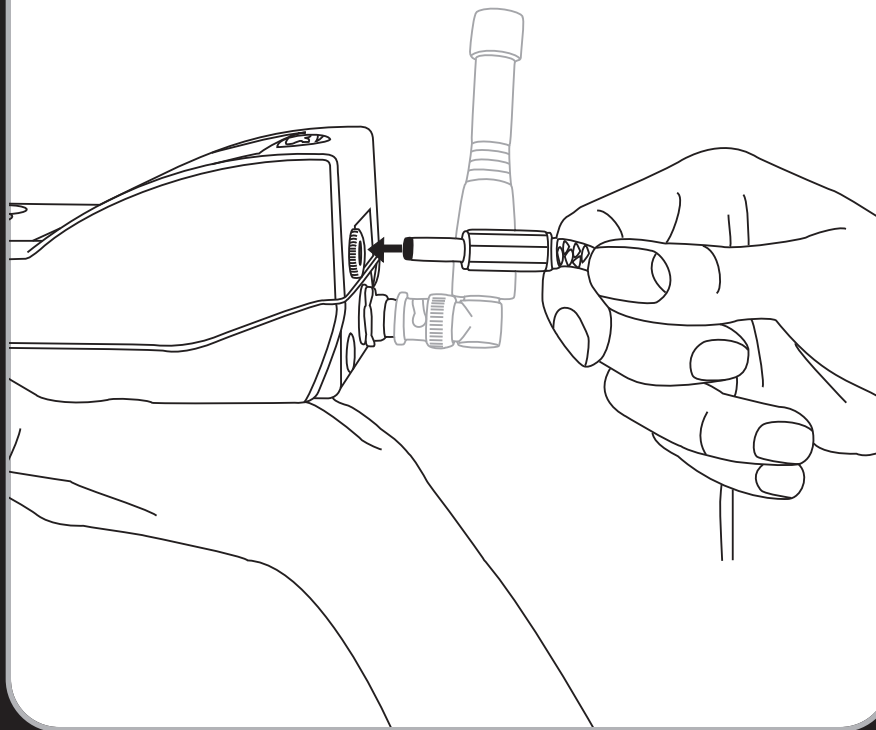

4

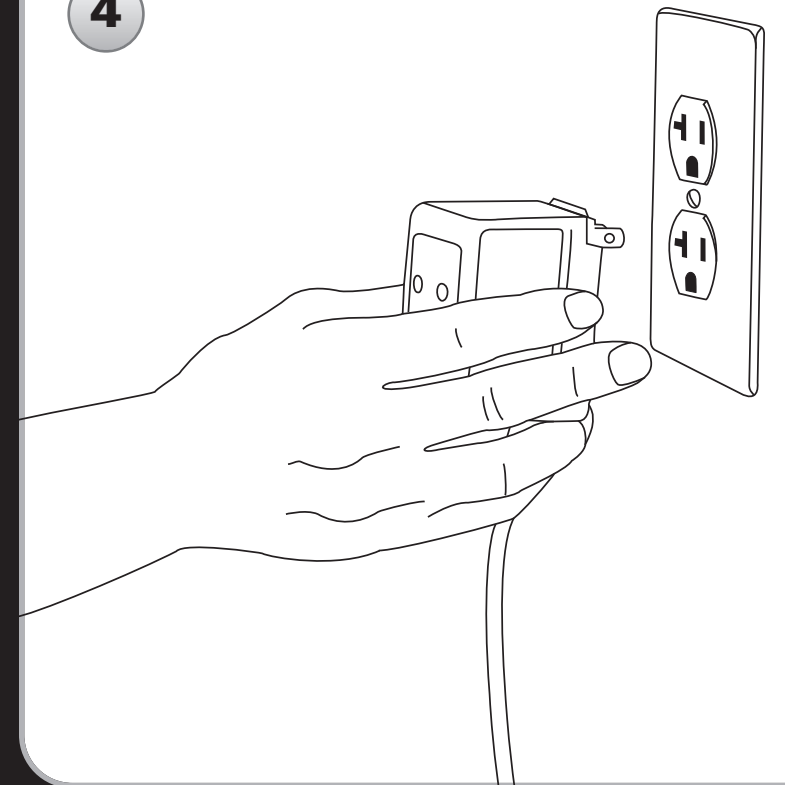

5



6

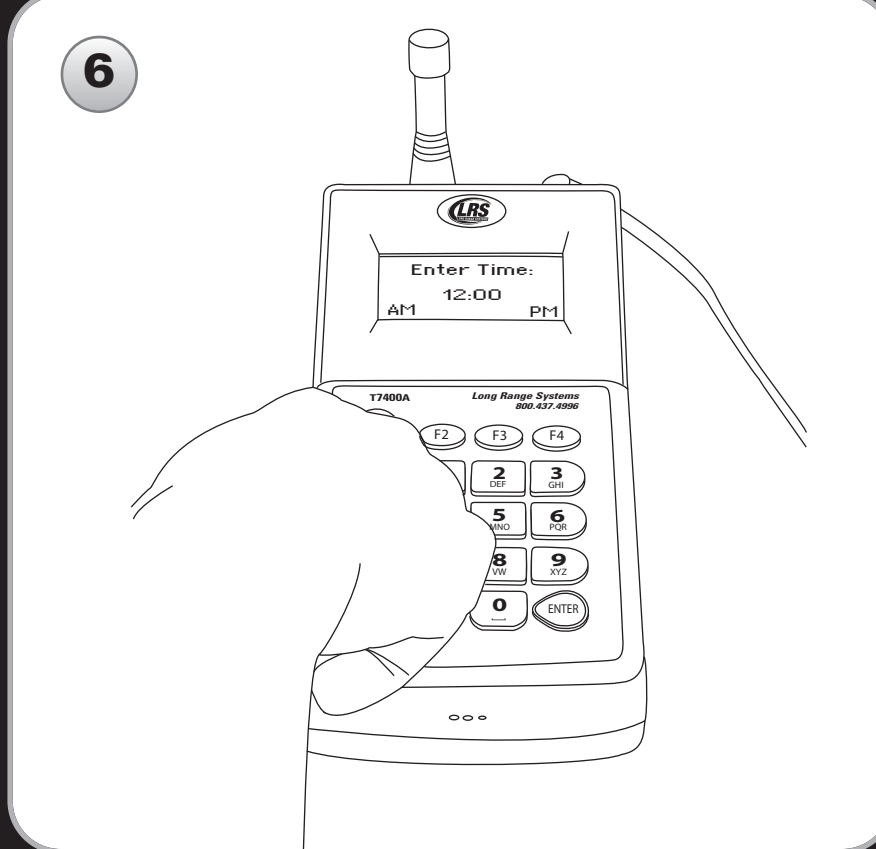

7

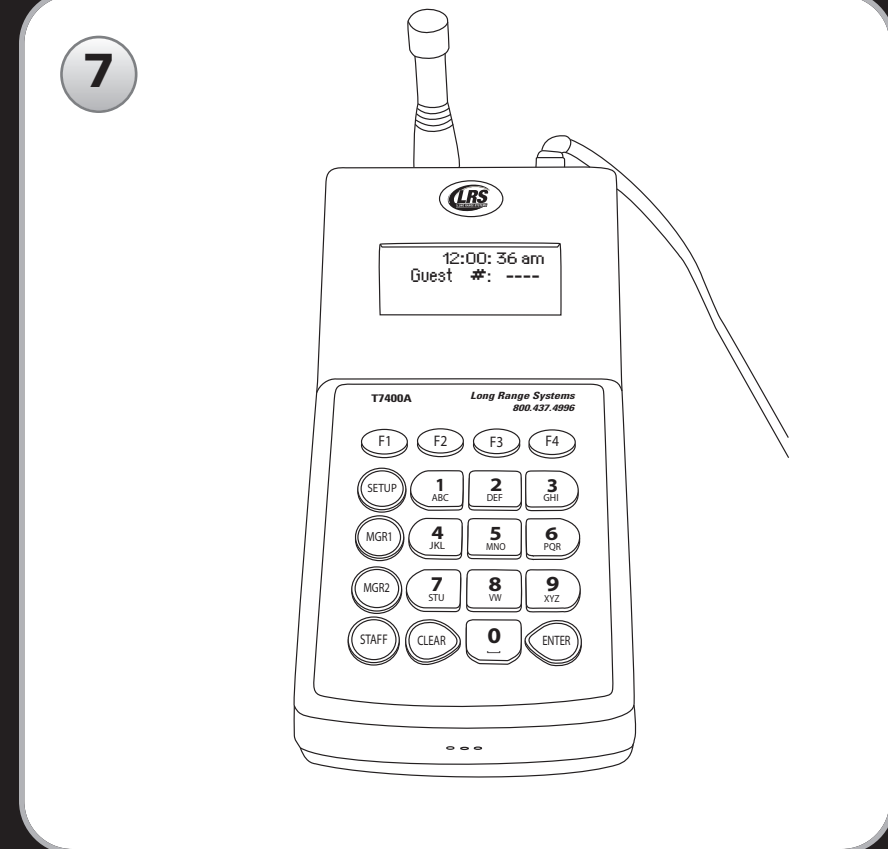

T7400A BASIC OPERATIONS GUIDE

PAGING

Guest Pagers: Return guest pagers to charging unit after paging

Non-Alphanumeric (Adverteaser, Pizza, Lobster, Coaster Call pagers)

1. Main screen displays – Guest #: - - - -
2. Enter pager number assigned to guest at handout
3. Press **ENTER** to send page

Alphanumeric (Alpha Coaster pager)

1. Main screen displays – Guest #: Guest #: - - - -
2. Enter pager number assigned to guest at handout
3. Enter code (000-099) (see Preset Messages Table)
4. Press **ENTER** to send page
(You may also Press **F1** (V1), **F2** (V2) or **F3** (V3) to send the message with 1, 2 or 3 vibrations or **F4** (Exit) to Cancel the page)

Staff Pagers

Non-Alphanumeric (Star Pager)

1. On keypad press **STAFF** (Display = Staff #: - - - -)
2. Enter staff pager number to be paged
3. Press **ENTER** to send page

Alphanumeric (Rechargeable or Battery Operated Alphanumeric pagers)

1. On keypad press **STAFF** (Display = Pager #: - - - -)
2. Enter staff pager number to be paged
3. Enter message code (000-099) (see Preset Messages Table)
4. Press **ENTER** to send page
(You may also Press **F1** (V1), **F2** (V2) or **F3** (V3) to send the message with 1, 2 or 3 vibrations or **F4** (Exit) to Cancel the page)

Assign Manager Pagers:

1. Press **SETUP**
2. Enter Password (Default: 5-6-7-8-9)
3. Press **1** System
4. Press **F2** (DN)
5. Press **1** MGR1/2 Btms

6. Select MGR1 Pager or MGR2 Pager
7. Enter pager number assigned to that manager
8. Press **ENTER**

Page a Manager Pager:

1. On keypad press **MGR1** or **MGR2**
2. Press **F1** (YES) to continue or **F4** (NO) to cancel
3. Enter message number code (000-099) (see Preset Messages Table)
4. Choose **F1** (V1), **F2** (V2), **F3** (V3) or **F4** (Exit) for 1, 2 or 3 vibrations

All Staff Page: Page all alphanumeric staff pagers simultaneously

1. Press **STAFF**
2. Press 9-1-1 then **ENTER**
3. Enter message number code (000-099)
4. Choose **F1** (V1), **F2** (V2) or **F3** (V3) for 1, 2 or 3 vibrations

PRESET MESSAGES

Using Message Codes

When prompted for a message:

1. Enter message number code
(and a numeric extension – optional)
2. Press **ENTER**

Example: Send a message to call extension 123

From the Preset Message Table to the right, choose – 006 (Call Ext)
Enter code 0-0-6-1-2-3 (Displays: CALL EXT 123)

Create Additional Alpha Messages: For Alpha pagers only

1. Press **SETUP**
2. Enter Password (Default: 5-6-7-8-9)
3. Press **3** Other
5. Press **1** (Preset Msgs.)
6. Press **F1** (EDIT)
7. Press **F2** (NEW) to write a new message (Press **F1** (EDIT) to edit displayed message)
8. Enter message using alphanumeric typing (i.e. for letter 'E' press #2 twice)
9. Press **ENTER** to save then **F4** (EXIT) when finished

MISC. FUNCTIONS

Anti-Theft Mode: (Signal pagers that are out of range)

1. Press **SETUP**
2. Enter Password (Default: 5-6-7-8-9)
3. Press **1** System
2. Press **1** Anti-Theft
3. Press **F1** (ON) to activate anti-theft mode or (press **F4** to turn OFF)
4. Main screen display will show "T" on upper left corner when turned on

Set Time/Date:

1. Press **SETUP**
2. Enter Password (Default: 5-6-7-8-9)
3. Press **1** System
3. Press **2** Date/Time
4. Press **1** for Date Format, Press **2** for Time Format, Press **3** to Set Date, or Press **F2** (DN-Down) then Press **1** to Set Time

For advanced features, go to www.pager.net to download a complete user manual.
For technical support call Long Range Systems at 800-437-4996.

Preset Message Codes

Code Message

| | | | |
|-----------------------|--------------------------|-----------------------|--------------------------|
| 000 Phone Call | 020 Starter | 040 Door | 060 Car |
| 001 Sales Call | 021 Service drive | 041 Survey | 061 Bus |
| 002 Manager | 022 Showroom | 042 T-nnn Q-mm | 062 Bay |
| 003 Customer | 023 Parked Call | 043 Break | 063 Low battery |
| 004 Room | 024 Voice Mail | 044 Fire | 064 Error |
| 005 Visitor | 025 Dressing room | 045 Unit | 065 Exit |
| 006 Call Ext | 026 Price check | 046 Window | 066 Fax |
| 007 MTG Room | 027 Department | 047 Nurse | 067 Host |
| 008 Lane | 028 Cashier | 048 Register | 068 Space |
| 009 Aisle | 029 Office | 049 Owner | 069 Location |
| 010 Void | 030 Table | 050 Check | 070 Nursery |
| 011 Stamps | 031 Winner | 051 Drink | 071 Teller |
| 012 Change | 032 Pickup | 052 Food | 072 Officer |
| 013 Station | 033 Dock | 053 Service | 073 Buffet |
| 014 Machine | 034 You have mail | 054 Seat | 074 Diaper change |
| 015 Operator | 035 Table ready | 055 Booth | 075 Child crying |
| 016 Emergency | 036 No special | 056 Lobby | 076 To nursery |
| 017 XX Minutes | 037 Hole | 057 Help | |
| 018 Tee | 038 Kitchen | 058 Restroom | |
| 019 Pro Shop | 039 Bar | 059 Valet | |

